

产品特点

- CGA钢瓶接头
- 连接到钢瓶阀
- 1/4" NPT外螺纹(CGA180 1/8NPT)

类型	螺纹	材质	气体
CGA160	1/8"- 27 NGT-RH-INT	黄铜电镀	光气
CGA180	.625"-18UNF RH EXT	黄铜电镀	小钢瓶,非腐蚀性气体
CGA300	.825"-14 NGO RH EXT	黄铜电镀	C ₂ H ₂
CGA320	.825"-14 NGO RH EXT	黄铜电镀	CO ₂
CGA326	.825"-14 NGO RH EXT	黄铜电镀	N ₂ O
CGA346	.825"-14 NGO RH EXT	黄铜电镀	Air
CGA350	.825"-14 NGO LH EXT	黄铜电镀	H ₂ , CH ₄ , CO
CGA510	.885"-14 NGO LH INT	黄铜电镀	C ₂ H ₂ , C ₃ H ₈ , C ₄ H ₁₀ , C ₂ H ₄ O
CGA540	.903"-14 NGO RH EXT	黄铜电镀	O ₂
CGA580	.965"-14 NGO RH INT	黄铜电镀	N ₂ , Ar, He
CGA590	.965"-14 NGO LH INT	黄铜电镀	Air, He
CGA660	1.03"-14 RH EXT	黄铜电镀	CO ₂ , Cl ₂
CGA180	.625"-18UNF RH EXT	316L	小钢瓶,非腐蚀性气体
CGA300	.825"-14 NGO RH EXT	316L	C ₂ H ₂
CGA320	.825"-14 NGO RH EXT	316L	CO ₂
CGA326	.825"-14 NGO RH EXT	316L	N ₂ O
CGA346	.825"-14 NGO RH EXT	316L	Air
CGA350	.825"-14 NGO LH EXT	316L	H ₂ , CH ₄ , CO
CGA510	.885"-14 NGO LH INT	316L	C ₂ H ₂ , C ₃ H ₈ , C ₄ H ₁₀ , C ₂ H ₄ O
CGA540	.903"-14 NGO RH EXT	316L	O ₂
CGA580	.965"-14 NGO RH INT	316L	N ₂ , Ar, He
CGA590	.965"-14 NGO LH INT	316L	Air, He
CGA660	1.03"-14 RH EXT	316L	CO ₂ , Cl ₂

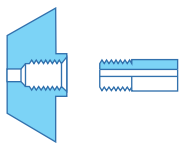

CGA 160 1/8" -27 NGT RH INT.

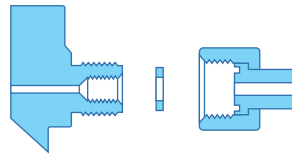

CGA 180 .625" -18 UNF 2A RH EXT.
带垫片

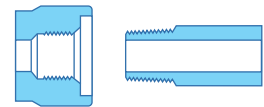

CGA 240 3/8" -18 NGT -RH INT.

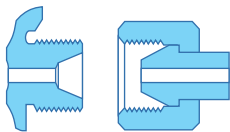

CGA 300 .825" -14 NGO RH EX.

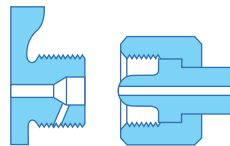

CGA 326 .825" -14 RH EXT.

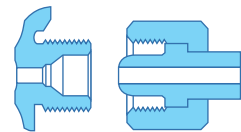

CGA 346 .825" -14 NGO.

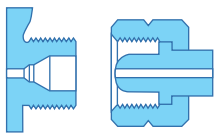

CGA 350 .825" -14 LH EXT.

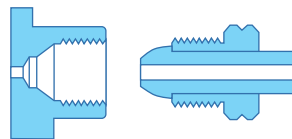

CGA 510 .885" -14 LH INT.

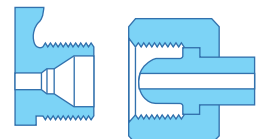

CGA 540 .903" -14 RH .

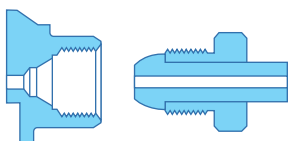

CGA 580 .965" -14 RH INT.

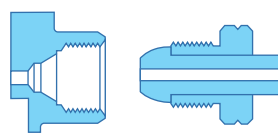

CGA 590 .965" -14 NGO LH INT.

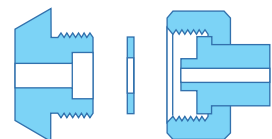

CGA 660 1.03" -14
带垫片



技术参数

材质	
螺母:	SS 316
堵头:	SS 316L
阀盖:	SS 316L
垫片:	不锈钢



螺母、螺纹接头和垫片

型号	端口连接	F 六角螺母 in.
632 ~ 642	1/4" 焊接管	1-1/4
	1/2" 焊接管	
	1/4" 密封件	
	1/4" NPT(M)	
712 ~ 728	1/4" 焊接管	1-3/8
	1/2" 焊接管	
	1/4" 密封件	
	1/4" NPT(M)	

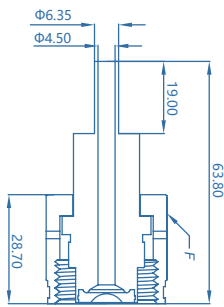

1/4" 焊接管

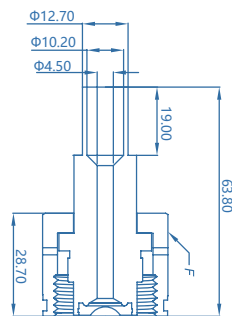

1/2" 焊接管

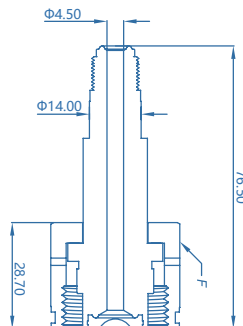

1/4" 密封件

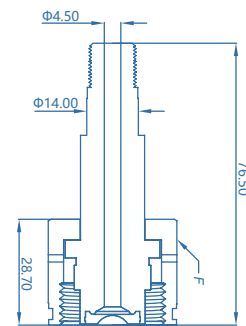

1/4" NPT(M)

堵帽

型号	订购编号	材质	F 六角螺母 in.	H 长度 in.	密封
632 ~ 642	CGA-DISS-C-63	不锈钢	1-1/4	0.98	有
712 ~ 728	CGA-DISS-C-71		1-3/8		

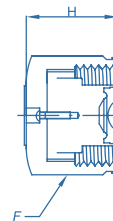

垫圈

材质	订购编号	A	H	E
不锈钢	CGA-DISS-G-NI	0.56	0.105	0.21
PCTFE	CGA-DISS-G-PC		0.125	

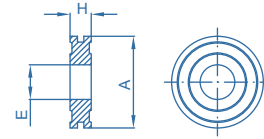

堵塞, 转接头

型号	订购编号	连接端口	H 总长度	F 六角螺母 in.
632 ~ 642	CGA-DISS-BP-63	堵塞	1.53	1-1/8
	CGA-DISS-A-F4-63	1/4" NPT(F)	1.85	
712 ~ 718	CGA-DISS-BP-71	堵塞	1.53	1-1/4
	CGA-DISS-A-F4-71	1/4" NPT(F)	1.85	
720 ~ 728	CGA-DISS-BP-72	堵塞	1.53	1-1/4
	CGA-DISS-A-F4-72	1/4" NPT(F)	1.85	

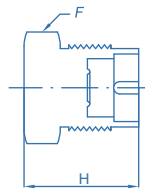

堵塞

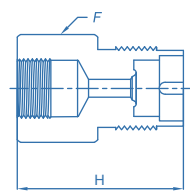

转接头

订购参数

CGA-DISS- NNG - CGA632 - TW4 - Ni

产品类型

N: 螺母

P: 螺纹接头

NNG: 螺母, 螺纹接头, 垫圈

垫片材质

Ni: Nickle

PC: PCTFE

型号

CGA632	CGA642	CGA720
CGA634	CGA712	CGA722
CGA636	CGA714	CGA724
CGA638	CGA716	CGA726
CGA640	CGA718	CGA728

端口连接

MV4: 1/4" 密封件

TW4: 1/4" 焊接管

TW8: 1/2" 焊接管

M4: 1/4" NPT(M)

*其他连接标准, 请咨询经销商

