

Low-pressure Diaphragm Valve Manifold VDV36UB Series

VIGOUR

Product Feature

- Excellent degassing characteristics is achieved through minimized flow paths by combining 2 of VDV32 diaphragm valves together in one valve body.
- Fewer welds over standard valve alignments
- Reduces space requirements
- Compact tubing arrangement
- Dead space free configuration



Dimensions (mm)

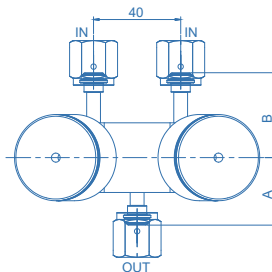
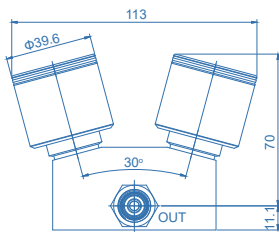

End Connections	Dimensions (mm)	
	A	B
VFS Female	31	39
VFS Male	46.3	46.3

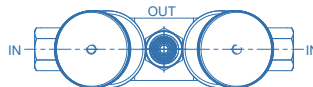
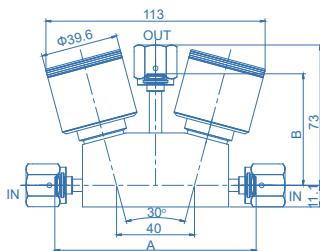

End Connections	Dimensions (mm)	
	A	B
VFS Female	103.4	57.3
VFS Male	139.6	70

Technical Data

Max. Working Pressure:	150 psig (10bar)
Actuation Pressure:	58~87psig (4~6bar)
Max. Working Temp.:	14°F ~ 104°F (-10°C ~ 40°C)
Surface finish:	10µin. Ra
Materials	
Body:	see ordering info
Diaphragm:	Elgiloy®
Seat packing:	PCTFE
Handle:	AL
Internal Leakage Allowance:	1x10 ⁻⁹ mbar l/s He
External Leakage Allowance:	1x10 ⁻⁹ mbar l/s He
Flow capacity:	Cv=0.3
Weight:	approx. 1.36kg (depending on connections or options)



Ordering information

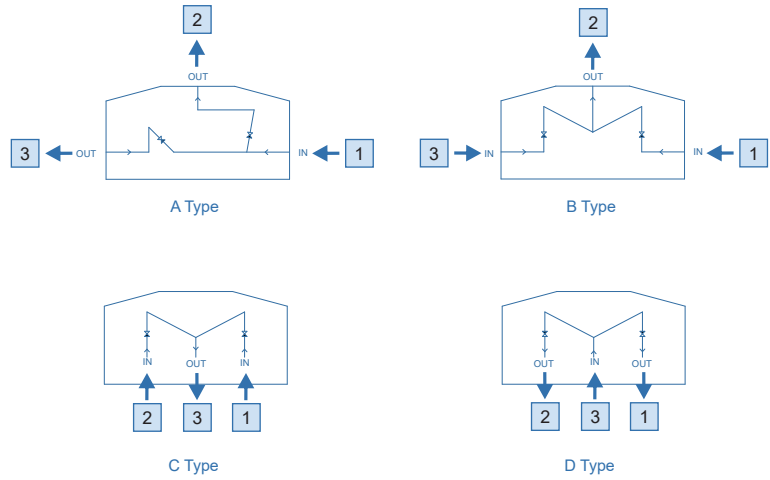

Inlet/Outlet Connection

MV4: 1/4" VFS male
 FV4: 1/4" VFS female
 TW4: 1/4" tube weld

* Other connection standard, consult factory.

Port Selection

VDV36UBS - A - PC - PC - 1 - 2 - 3 - P

Materials

S: 316L

Flow Rate

A: A Type
 B: B Type
 C: C Type
 D: D Type

Valve1 Actuator

M: manual actuator
 PO: pneumatic actuator, normally opened
 PC: pneumatic actuator, normally closed

Process Specification

None: VS001B
 P: VS001A

* For details, please refer to the appendix.

Valve2 Actuator*

M: manual actuator
 PO: pneumatic actuator, normally opened
 PC: pneumatic actuator, normally closed

* When the actuators are the same there will be one symbol.

Ordering Example

VDV36UBS - C - PC - PC - FV4 - FV4 - FV4

1 - 2 - 3



Low-pressure Diaphragm Valve Manifold VDV36UC Series

VIGOUR

Product Feature

- Excellent degassing characteristics is achieved through minimized flow paths by combining 2 of VDV32 diaphragm valves together in one valve body.
- Fewer welds over standard valve alignments
- Reduces space requirements
- Compact tubing arrangement
- Dead space free configuration



Dimensions (mm)

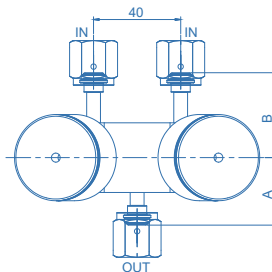
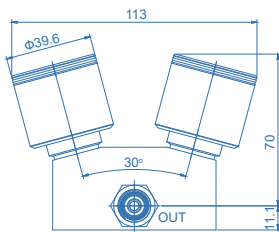

End Connections	Dimensions (mm)	
	A	B
VFS Female	31	39
VFS Male	46.3	46.3

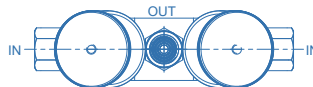
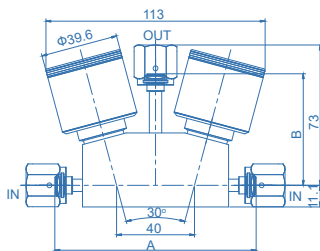

End Connections	Dimensions (mm)	
	A	B
VFS Female	103.4	57.3
VFS Male	139.6	70

Technical Data

Max. Working Pressure:	150 psig (10bar)
Actuation Pressure:	58~87psig (4~6bar)
Max. Working Temp.:	14°F ~ 104°F (-10°C ~ 40°C)
Surface finish:	7µin. Ra
Materials	
Body:	see ordering info
Diaphragm:	Elgiloy®
Seat packing:	PCTFE
Handle:	AL
Internal Leakage Allowance:	1x10 ⁻⁹ mbar l/s He
External Leakage Allowance:	1x10 ⁻⁹ mbar l/s He
Flow capacity:	Cv=0.1
Weight:	approx. 1.36kg (depending on connections or options)



Ordering information

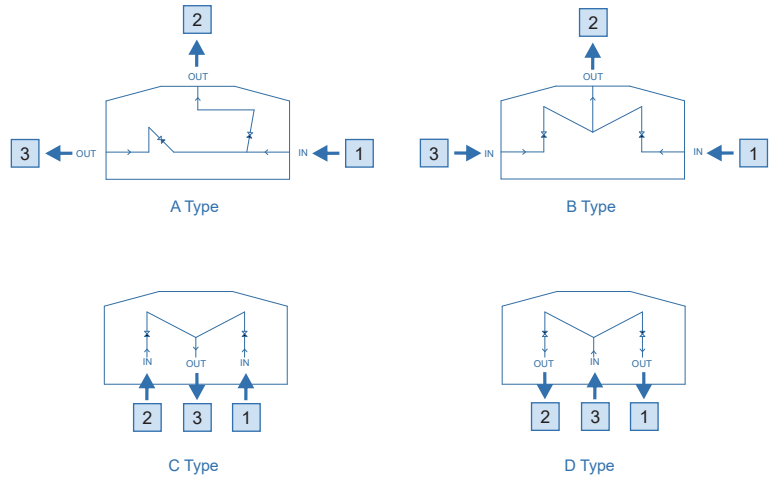

Inlet/Outlet Connection

MV4: 1/4" VFS male
 FV4: 1/4" VFS female
 TW4: 1/4" tube weld

* Other connection standard, consult factory.

Port Selection

VDV36UCSLV - A - PC - PC - 1 - 2 - 3 - P

Materials
SLV: 316L secondary remelt

Flow Rate
A: A Type
B: B Type
C: C Type
D: D Type

Valve1 Actuator
M: manual actuator
PO: pneumatic actuator, normally opened
PC: pneumatic actuator, normally closed

Process Specification
P: VS001A
* For details, please refer to the appendix.

Valve2 Actuator*
M: manual actuator
PO: pneumatic actuator, normally opened
PC: pneumatic actuator, normally closed
* When the actuators are the same there will be one symbol.

Ordering Example

VDV36UCSLV - C - PC - PC - FV4 - FV4 - FV4
 1 - 2 - 3

