

## Product Feature

- Suitable for ultra-pure, flammable or toxic fluid lines in semiconductor manufacturing equipment and facilities
- Direct diaphragm construction with superior sealing performance, remarkable durability, compactness and particle free performance
- Valve open and closed position is easily visible at a glance
- Excellent gas displacement characteristics
- EP treatment is standard for all wetted surfaces
- Standard seat material is PCTFE, Polyimide is option

## Temperature / Pressure Rating

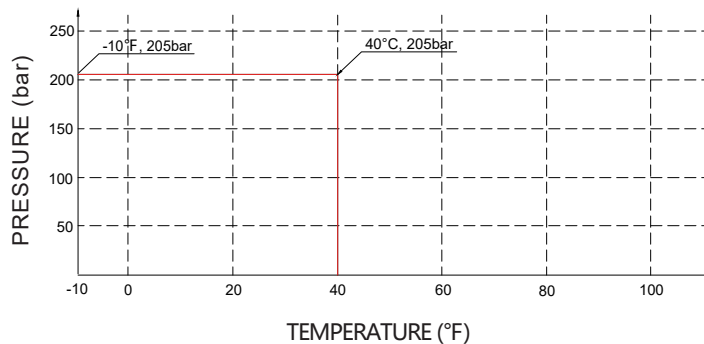

1/2" pneumatic actuator



1/2" manual actuator



1/2" Right-angle handle



3/4" manual actuator (Lockable)

## Technical Data

Max. Working Pressure:	3000 psig (200bar) / 1300 psig (90bar)
Actuation Pressure:	70~110 psig (5~8bar)
Max. Working Temp.:	-40°F ~ 150°F (-40°C ~ 65°C)
Surface finish:	10µin. Ra
Materials	
Body:	see ordering info
Diaphragm:	Elgiloy®
Seat packing:	PCTFE
Handle:	AL
Internal Leakage Allowance:	1x10 <sup>-9</sup> mbar·l/s He
External Leakage Allowance:	1x10 <sup>-9</sup> mbar·l/s He
Flow capacity:	manual actuator Cv=1.0 pneumatic actuator Cv=1.0 (90bar) / Cv=0.7 (206 bar)
Weight:	approx. 1.36kg (depending on connections or options)



## Dimensions (mm)

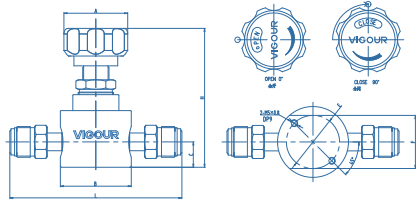

manual actuator (90 bar)

End Connections	Orifice (mm)	Dimensions (mm)							
		A	B	C	E	F	L	H	
1/4" VFS male	4.4	Φ47.8	50.8	18.2	Φ38.1	38	101.6	100	
1/4" VFS female	4.4	Φ47.8	50.8	18.2	Φ38.1	38	101.6	100	
1/2" VFS male	7	Φ47.8	50.8	18.2	Φ38.1	38	123.2	100	
1/2" VFS female	7	Φ47.8	50.8	18.2	Φ38.1	38	123.2	100	
3/4" VFS male	7	Φ47.8	50.8	18.2	Φ38.1	38	177.8	100	
3/4" VFS female	7	Φ47.8	50.8	18.2	Φ38.1	38	177.8	100	
3/8" Tube weld	7	Φ47.8	50.8	18.2	Φ38.1	38	69.8	100	
1/2" Tube weld	7	Φ47.8	50.8	18.2	Φ38.1	38	90.8	100	
3/4" Tube weld	7	Φ47.8	50.8	18.2	Φ38.1	38	165.2	100	

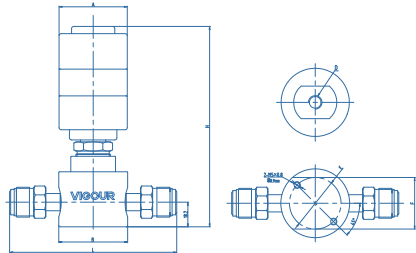

pneumatic actuator (normally closed 90 bar)

End Connections	Orifice (mm)	Dimensions (mm)								
		A	B	C	D	E	F	L	H	
1/4" VFS male	4.4	Φ50.3	50.8	18.2	M5x0.8	Φ38.1	38	101.6	148	
1/4" VFS female	4.4	Φ50.3	50.8	18.2	M5x0.8	Φ38.1	38	101.6	148	
1/2" VFS male	7	Φ50.3	50.8	18.2	M5x0.8	Φ38.1	38	123.2	148	
1/2" VFS female	7	Φ50.3	50.8	18.2	M5x0.8	Φ38.1	38	123.2	148	
3/4" VFS male	7	Φ50.3	50.8	18.2	M5x0.8	Φ38.1	38	177.8	148	
3/4" VFS female	7	Φ50.3	50.8	18.2	M5x0.8	Φ38.1	38	177.8	148	
3/8" Tube weld	7	Φ50.3	50.8	18.2	M5x0.8	Φ38.1	38	69.8	148	
1/2" Tube weld	7	Φ50.3	50.8	18.2	M5x0.8	Φ38.1	38	90.8	148	
3/4" Tube weld	7	Φ50.3	50.8	18.2	M5x0.8	Φ38.1	38	165.2	148	

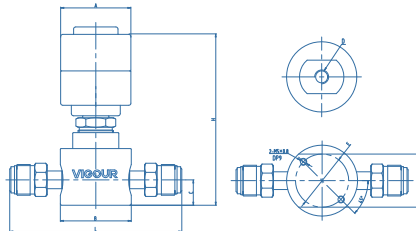

pneumatic actuator (normally closed 206 bar)

End Connections	Orifice (mm)	Dimensions (mm)								
		A	B	C	D	E	F	L	H	
1/4" VFS male	4.4	Φ50.3	50.8	18.2	M5x0.8	Φ38.1	38	101.6	125	
1/4" VFS female	4.4	Φ50.3	50.8	18.2	M5x0.8	Φ38.1	38	101.6	125	
1/2" VFS male	7	Φ50.3	50.8	18.2	M5x0.8	Φ38.1	38	123.2	125	
1/2" VFS female	7	Φ50.3	50.8	18.2	M5x0.8	Φ38.1	38	123.2	125	
3/4" VFS male	7	Φ50.3	50.8	18.2	M5x0.8	Φ38.1	38	177.8	125	
3/4" VFS female	7	Φ50.3	50.8	18.2	M5x0.8	Φ38.1	38	177.8	125	
3/8" Tube weld	7	Φ50.3	50.8	18.2	M5x0.8	Φ38.1	38	69.8	125	
1/2" Tube weld	7	Φ50.3	50.8	18.2	M5x0.8	Φ38.1	38	90.8	125	
3/4" Tube weld	7	Φ50.3	50.8	18.2	M5x0.8	Φ38.1	38	165.2	125	

## Ordering Information

### VDV38UBS - M - MV8 - MV8 - VS - H - L - P

#### Materials

S: 316L

#### Actuator

M: manual actuator

PC: pneumatic actuator (normally closed)

#### End Connection

MV4: 1/4" VFS male

FV4: 1/4" VFS female

MV8: 1/2" VFS male

FV8: 1/2" VFS female

TW6: 3/8" tube weld

TW8: 1/2" tube weld

MV12: 3/4" VFS male

FV12: 3/4" VFS female

TW12: 3/4" tube weld

\* Other connection standard, consult factory

#### Valve Seat Option

None: PCTFE (standard)

VS: VespeI®

#### Process Specification

None: VS001B

P: VS001A

\* For details, please refer to the appendix..

#### Optional

None: Circular handle

LO: Round Knob

Pull, then turn to open  
lock out / tag out

L: Right-angle handle

#### Work Pressure

H: 3000 psig \*

M: 1300 psig

\*Manual actuator: Only right-angle handwheel is rated for 3000 psig.

\*The pressure for the 3/4" connection is 1650 psig.



## Product Feature

- Suitable for ultra-pure, flammable or toxic fluid lines in semiconductor manufacturing equipment and facilities
- Direct diaphragm construction with superior sealing performance, remarkable durability, compactness and particle free performance
- Valve open and closed position is easily visible at a glance
- Excellent gas displacement characteristics
- EP treatment is standard for all wetted surfaces
- Standard seat material is PCTFE, Polyimide is option

## Temperature / Pressure Rating

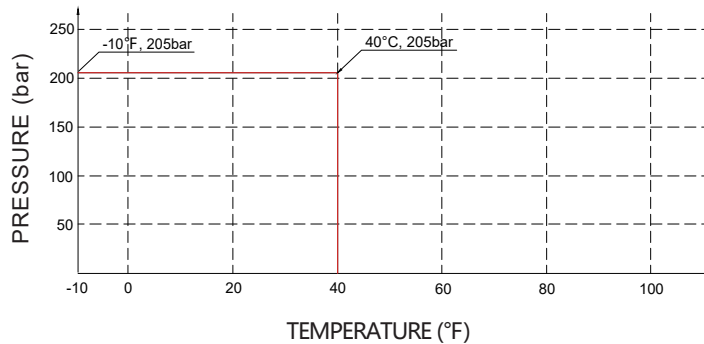

1/2" pneumatic actuator



1/2" manual actuator



1/2" Right-angle handle



3/4" manual actuator (Lockable)

## Technical Data

Max. Working Pressure:	3000 psig (200bar) / 1300 psig (90bar)
Actuation Pressure:	70~110 psig (5~8bar)
Max. Working Temp.:	-40°F ~ 150°F (-40°C ~ 65°C)
Surface finish:	7µin. Ra
<b>Materials</b>	
Body:	see ordering info
Diaphragm:	Elgiloy®
Seat packing:	PCTFE
Handle:	AL
Internal Leakage Allowance:	1x10 <sup>-9</sup> mbar·l/s He
External Leakage Allowance:	1x10 <sup>-9</sup> mbar·l/s He
Flow capacity:	manual actuator Cv=1.0 pneumatic actuator Cv=1.0 (90bar) / Cv=0.7 (206 bar)
Weight:	approx. 1.36kg (depending on connections or options)



## Dimensions (mm)

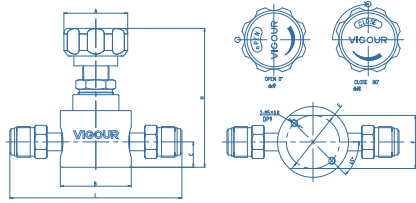

manual actuator (90 bar)

End Conections	Orifice (mm)	Dimensions (mm)						
		A	B	C	E	F	L	H
1/4" VFS male	4.4	Φ47.8	50.8	18.2	Φ38.1	38	101.6	100
1/4" VFS female	4.4	Φ47.8	50.8	18.2	Φ38.1	38	101.6	100
1/2" VFS male	7	Φ47.8	50.8	18.2	Φ38.1	38	123.2	100
1/2" VFS female	7	Φ47.8	50.8	18.2	Φ38.1	38	123.2	100
3/4" VFS male	7	Φ47.8	50.8	18.2	Φ38.1	38	177.8	100
3/4" VFS female	7	Φ47.8	50.8	18.2	Φ38.1	38	177.8	100
3/8" Tube weld	7	Φ47.8	50.8	18.2	Φ38.1	38	69.8	100
1/2" Tube weld	7	Φ47.8	50.8	18.2	Φ38.1	38	90.8	100
3/4" Tube weld	7	Φ47.8	50.8	18.2	Φ38.1	38	165.2	100

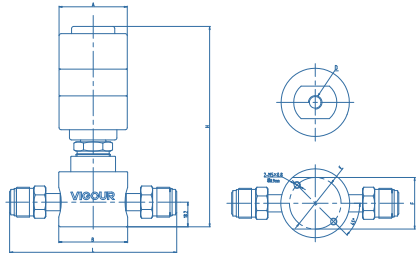

pneumatic actuator (normally closed 90 bar)

End Conections	Orifice (mm)	Dimensions (mm)							
		A	B	C	D	E	F	L	H
1/4" VFS male	4.4	Φ50.3	50.8	18.2	M5x0.8	Φ38.1	38	101.6	148
1/4" VFS female	4.4	Φ50.3	50.8	18.2	M5x0.8	Φ38.1	38	101.6	148
1/2" VFS male	7	Φ50.3	50.8	18.2	M5x0.8	Φ38.1	38	123.2	148
1/2" VFS female	7	Φ50.3	50.8	18.2	M5x0.8	Φ38.1	38	123.2	148
3/4" VFS male	7	Φ50.3	50.8	18.2	M5x0.8	Φ38.1	38	177.8	148
3/4" VFS female	7	Φ50.3	50.8	18.2	M5x0.8	Φ38.1	38	177.8	148
3/8" Tube weld	7	Φ50.3	50.8	18.2	M5x0.8	Φ38.1	38	69.8	148
1/2" Tube weld	7	Φ50.3	50.8	18.2	M5x0.8	Φ38.1	38	90.8	148
3/4" Tube weld	7	Φ50.3	50.8	18.2	M5x0.8	Φ38.1	38	165.2	148

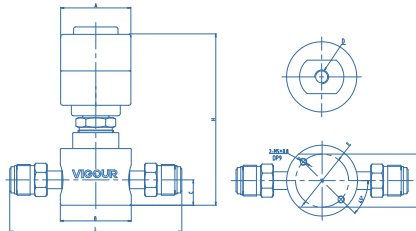

pneumatic actuator (normally closed 206 bar)

End Conections	Orifice (mm)	Dimensions (mm)							
		A	B	C	D	E	F	L	H
1/4" VFS male	4.4	Φ50.3	50.8	18.2	M5x0.8	Φ38.1	38	101.6	125
1/4" VFS female	4.4	Φ50.3	50.8	18.2	M5x0.8	Φ38.1	38	101.6	125
1/2" VFS male	7	Φ50.3	50.8	18.2	M5x0.8	Φ38.1	38	123.2	125
1/2" VFS female	7	Φ50.3	50.8	18.2	M5x0.8	Φ38.1	38	123.2	125
3/4" VFS male	7	Φ50.3	50.8	18.2	M5x0.8	Φ38.1	38	177.8	125
3/4" VFS female	7	Φ50.3	50.8	18.2	M5x0.8	Φ38.1	38	177.8	125
3/8" Tube weld	7	Φ50.3	50.8	18.2	M5x0.8	Φ38.1	38	69.8	125
1/2" Tube weld	7	Φ50.3	50.8	18.2	M5x0.8	Φ38.1	38	90.8	125
3/4" Tube weld	7	Φ50.3	50.8	18.2	M5x0.8	Φ38.1	38	165.2	125

## Ordering Information

### VDV38UCSLV - M - MV8 - MV8 - VS - H - L - P

#### Materials

SLV: 316L secondary remelt

#### Actuator

M: manual actuator

PC: pneumatic actuator (normally closed)

#### End Connection

MV4: 1/4" VFS male

FV4: 1/4" VFS female

MV8: 1/2" VFS male

FV8: 1/2" VFS female

\* Other connection standard, consult factory

TW6: 3/8" tube weld

TW8: 1/2" tube weld

MV12: 3/4" VFS male

FV12: 3/4" VFS female

TW12: 3/4" tube weld

#### Valve Seat Option

None: PCTFE (standard)

VS: VespeI®

#### Process Specification

P: VS001A

\* For details, please refer to the appendix..

#### Optional

None: Circular handle

LO: Round Knob

Pull, then turn to open  
lock out / tag out

L: Right-angle handle

#### Work Pressure

H: 3000 psig \*

M: 1300 psig

\*Manual actuator: Only right-angle handwheel is rated for 3000 psig.

\*The pressure for the 3/4" connection is 1650 psig.

