

### Product Features

- Line pressure regulator
- Stainless steel 316L body
- 4 ports configuration
- Stable outlet pressure

### Typical Applications

- Pharmaceutical Industry
- Food and Beverage Industry



### Dimensions (mm)

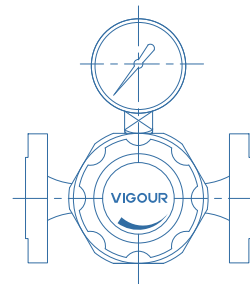
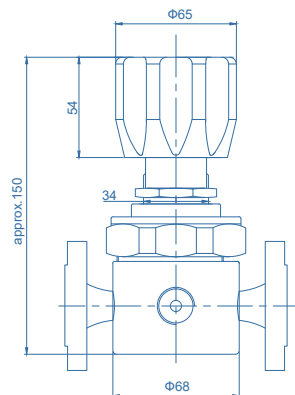

### Technical Data

Type:	single-stage
Inlet pressure P1:	max. 40 bar
Outlet pressure P2:	2/3/4/10/20/V2/V10 bar
Materials	
body regulator:	see ordering info
Valve seat:	PCTFE
Diaphragm:	Hastelloy® C276
O-ring:	Viton® (FKM)
(option)	Kalrez® (FFKM)
Filter:	SS 316L
Inlets and Outlets:	see ordering info
Temperature range:	-30°C to +74°C
Leak rate: (to atmosphere)	1x10 <sup>-8</sup> mbar l/s He
(via seat)	1x10 <sup>-6</sup> mbar l/s He
Flow capacity:	Cv=1.0
Weight:	3.2kg

### Flow Chart

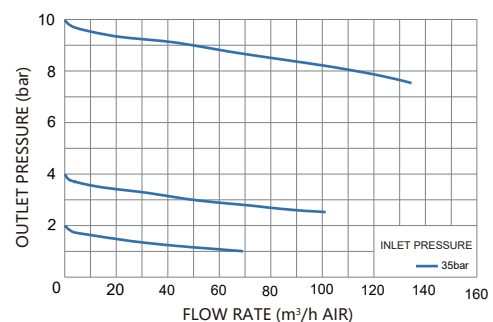

## Ordering Information

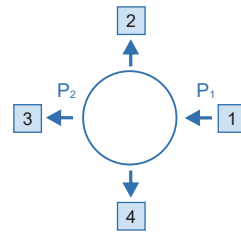

### Inlets / Outlets

D10: DN10 Flange  
D15: DN15 Flange  
D20: DN20 Flange

D25: DN25 Flange  
D30: DN30 Flange  
F4: 1/4"NPT(F)

P: Gauge (Psig/bar)  
B: Plug

\* Other connection standard, consult factory.

### Port Selection

VSR - 3F S - 40 - 10 - 1 - 2 - 3 - 4 - N<sub>2</sub>

### Body Material

S: 316L

### Inlet Pressure P<sub>1</sub>

10: 10 bar  
16: 16 bar  
25: 25 bar  
40: 40 bar

### Outlet Pressure P<sub>2</sub>

2: to 2 bar  
3: to 3 bar  
4: to 4 bar  
10: to 10 bar  
20: to 20 bar  
V2: 30 in Hg VAC ~ 2 bar  
V10: 30 in Hg VAC ~ 10 bar

### Type of Gas

Please specify type of gas

## Ordering Example

Example: VSR - 3FS - 40 - 10 - D10 - F4 - D10 - B - N<sub>2</sub>

1 - 2 - 3 - 4

